





mbeat[®]

TR166



Uptown

Retro Turntable & Cassette Player



SAFETY INSTRUCTION

**Thank you for purchasing mbeat retro turntable cassette player.
Read this instruction before operating this turntable player.
Keep the instruction for future reference.**

1. This product is for indoor use only. Do not use this product near water.
2. This product should be operated only by the type of power source indicated on the marking label or in this instruction manual.
3. Protect the power cord from being stepped on or pinched, particularly at the joints.
4. Do not overload wall outlets, extension cords, or integral convenience receptacles as this can result in a risk of fire or electric shock.
5. Never push objects of any kind into this product through openings as they may touch dangerous voltage points or short-out parts that could result in a fire or electric shock.
6. Never spill liquid of any kind onto the product.
7. Do not attempt to service this product yourself as opening or removing covers may expose you to dangerous voltage or other hazards. Refer all servicing to qualified service personnel.
8. Changes or modifications to this unit not expressly approved by the party responsible for compliance could void the user's authority to operate the equipment.
9. Do not use attachments not recommended by the product manufacturer as they may cause hazards.
10. Unplug the product in the event of a lightning storm or when unused for long periods of time.

PRODUCT CONTROLS

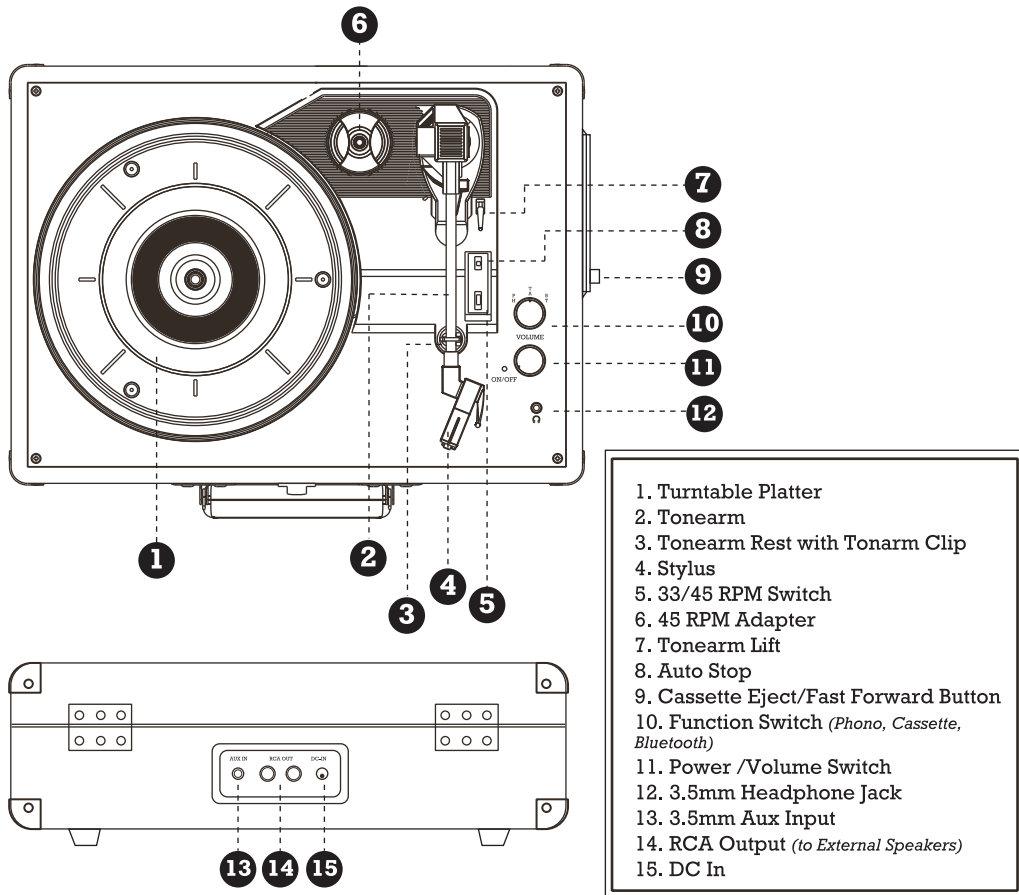

TURNTABLE PLAYER

Initial Setup-

1. Unpack and place the unit on a flat and level surface and free from vibration.
2. Remove the tie-wrap that is holding the tonearm.
3. Connect the DC adapter to the Power Jack of the unit.

Note: Do not plug the AC power adaptor to power outlet before the assembly is completed. Before turning the power on, make sure all the connection settings are correct. Always turn off the power first when connecting or disconnecting.

Play Back Function-

1. Turn the [Function Switch] to Phono mode “PH”. Rotate the [On/Off] button to turn on the power.
2. Set the [33/45 RPM Switch] accordingly.
3. Place the record on the turntable. Use the [45 RPM Adapter] if necessary.
4. Remove the stylus protector from the stylus assembly.

Note: To avoid stylus damage, make sure the included stylus guard is in place whenever the turntable is being moved or cleaned.

5. Release the [Tonearm Clip].

Note: when the turntable is not in use, lock the tonearm with the tonearm clip.

6. Use the [Tonearm Lift] to raise the tonearm and gently move the tonearm over the record. Once the platter begins to spin, set the tonearm lift back to the down position, the tonearm will descend slowly onto the record and begin playing.
7. When the record is finished, use the tonearm lift again to raise the tonearm and then return it to the [Tonearm Rest]. Release the lift to lower the tonearm into the rest. To suspend playback, repeat the same steps.
8. Lock the tonearm clip to secure the tonearm.

Auto Stop Function-

If the [Auto Stop] Switch is set to the ON position, the platter will stop spinning automatically when the record plays to the end. In some cases, if the turntable stops playing before the end of the record, set the switch to OFF position to finish playing.

CASSETTE PLAYER

1. Turn the [Function Switch] to the Tape mode “TA”, insert cassette gently half way.
2. Push in cassette to start playing.
3. Press down the [Eject Button] fully to eject cassette out.
4. Press the button half way down and hold to fast forward.
5. When one side is finished, take out the cassette to play the reverse side.

BLUETOOTH RECEIVER

1. Turn the [Function Switch] to the Bluetooth mode “BT”, you will hear an activation sound from the unit.
2. Turn on the Bluetooth feature of your audio device, search Bluetooth ID for “MB-TR166” to pair.
3. Once your device is successfully paired with the unit, you will hear a short confirmation sound from the unit.
4. Play and stream music from your device to the unit.

OTHER FEATURES

RCA Output-

1. The RCA jacks output analog line-level signals and connects directly with a pair of active/powered speakers or other stereo system.
2. The red plug connects to the right channel while the white plug connects to the left channel.

Note: The RCA jacks are not designed to be connected directly to passive/unpowered speakers. If connected to the passive speakers, the volume will be very low.

3.5 AUX Input-

1. You can connect an audio device to this unit and play your music through its speakers.
2. To do this, connect the 3.5mm auxiliary cable between your audio device and the Aux In Jack of this unit to start playing the music.

Note: The aux in connection will automatically override the turntable function. To resume using the turntable, unplug the auxiliary cable from the aux in jack.

STYLUS REPLACEMENT

Removing Stylus-

1. Gently pull down the front edge of the stylus.
2. Pull the stylus forward.
3. Pull out and remove.

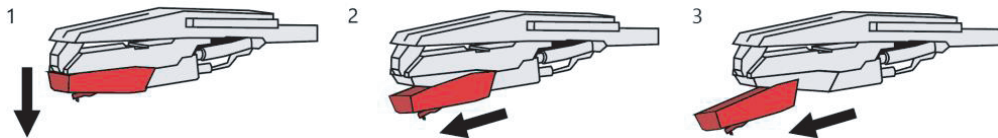

Installing Stylus-

1. Position the stylus with its tip facing down.
2. Line up the back of the stylus with the cartridge.
3. Insert the stylus with its front end at a downward angle and gently lift the front of the stylus upward until it snaps into place.

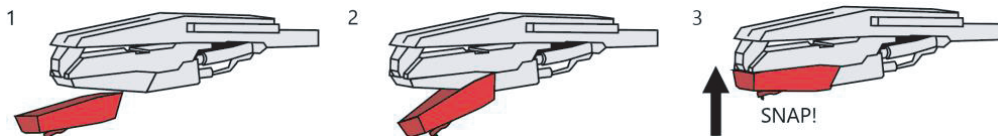

TURNTABLE MAINTENANCE

1. Do not touch the stylus tip with your fingers. Avoid bumping the stylus on the record's edge.
2. Clean the stylus frequently with a soft brush with a back-to-front motion only.
3. Clean the records to get rid of dust or grease with a record cleaning brush and record cleaning solution.
4. Clean the turntable lid and housing with a slightly damp microfiber cloth.

Note: Do not use cleaning agents that contains alcohol, benzene or any other harsh chemicals, which may damage the finish of the turntable.

TURNTABLE TROUBLE SHOOTING

No power?

1. Check if the DC power adaptor is not connected correctly.
2. Check if there is power at the power outlet.
3. To help save power consumption, some models will comply with ERP energy saving standard. When there is no audio input for 20 minutes, their powers will automatically cut-off. To turn power back on and resume playing, turn off the power and turn it on again.

Power on, but the turntable platter is not spinning?

1. Turntable's drive belt has slipped off.
2. An aux in cable is plugged into the aux in jack, unplug it.

Turntable is spinning, but there is no sound or low sound?

1. Stylus protector is still on or tonearm is lift up by the lift.
2. Headphone is plugged in.

Bluetooth is not paired?

1. Check if your phone or tablet's Bluetooth function is ON.
2. Search the correct turntable player's Bluetooth ID to pair.
3. Unpair the Bluetooth ID from your phone /tablet, and restart the pairing process.

Cassette player does not work?

1. Check if the turntable is switched to cassette mode.
2. Check if the cassette is pushed in fully.
3. Reverse the cassette A/B side and try it again.

CUSTOMER SUPPORT

Contact Information-



For product inquiry, manual or driver download, email to: support@mbeat.com.au
Visit www.mbeat.com.au for more product information.

Purchase Replacement Stylus-

Order from www.mbeat.com.au

Connect To Life.

 www.mbeat.com.au  support@mbeat.com.au

 [mbeat](https://www.facebook.com/mbeat)  [mbeat_australia](https://www.instagram.com/mbeat_australia)  [mbeataustralia](https://twitter.com/mbeataustralia)

CE  RoHS  Made in China Designed in Australia

— Rock Hard  Since 2009 —

www.mbeat.com.au

MB-TR166BLK 说明书

封面封底：180克米黄牛皮纸

内页：120克铜版纸

印刷：黑色 K=100

尺寸：140x140 mm

装订